



## ALUMINUM DRYWALL PROFILES



**EAGLE ARCHITECTURAL TRIMS**





## UPGRADE YOUR DRYWALL WITH EAGLE ARCHITECTURAL TRIMS



Shown in Black Satin Anodized Finish

Recognizing the critical role of drywall transitions in defining interior aesthetics, Eagle Aluminum's line of drywall trims are designed for swift and straightforward installation, ensuring clean, sharp edges that elevate the overall finish.

Available in profile depths of  $\frac{1}{2}$ " and  $\frac{5}{8}$ ", and readily accessible in convenient 10' lengths of Clear Satin Anodized and Mill Finish, these trims offer both wall protection and lasting visual appeal. Their precise profiles create impactful reveals and shadow lines, adding a layer of architectural sophistication to any commercial interior.

### GET A QUOTE

Contact an Eagle Sales Representative Today at **1-800-888-2044!**

### READY TO SHIP

- 10' Lengths (120 Inches)
- Clear Satin Anodized Finish (EA)
- Mill Finish (MF)

### PROFILE DEPTHS

- 0.500" (  $\frac{1}{2}$ " )
- 0.625" (  $\frac{5}{8}$ " )

### COMPOSITION

- 6063-T5 Extruded Aluminum

### FINISH OPTIONS

- Clear Satin Anodized (EA)
- Mill Finish (MF)
- Anodized Finishes
- Powder Coat Finishes

### ANODIZED FINISHES



Clear Satin  
AB1010



Champagne  
AA1020

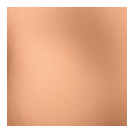

Rose Gold  
AA1090



Golden Bronze  
AA1030



Light Bronze  
AA1040

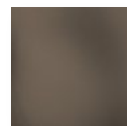

Medium Bronze  
AA1050



Dark Bronze  
AA1060

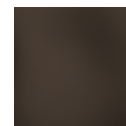

Deep Bronze  
AA1070



Black  
AA1080

### POWDER COAT FINISHES

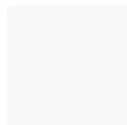

White  
PJ2210

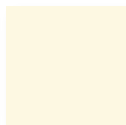

Cream  
PJ2220

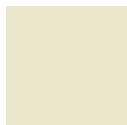

Almond  
PJ2230



Khaki  
PJ2240



Silver Gray  
PJ2250



Light Gray  
PJ2260



Dark Gray  
PJ2270



Medium Bronze  
PJ2050



Dark Bronze  
PJ2060

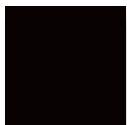

Black  
PJ2080

*Eagle Aluminum offers custom finishing, fabrication, and cutting services for all stocked and special order extrusions.*

## DRYWALL PROFILES - 5/8" Reveal Trims

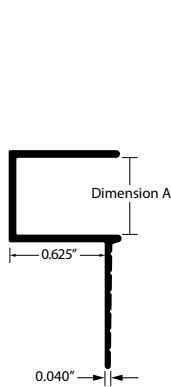
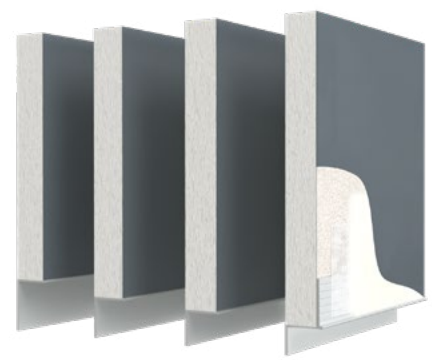

**EDW-F063**  
**F Reveal Trim for 5/8" Drywall**  
EA, MF

Item Number	Dimension A
EDW-F063-050	0.500" (1/2")
EDW-F063-063	0.625" (5/8")
EDW-F063-075	0.750" (3/4")
EDW-F063-100	1.00" (1")

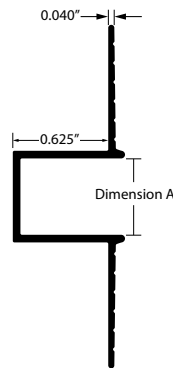

**EDW-U063**  
**U Reveal Trim for 5/8" Drywall**  
EA, MF

Item Number	Dimension A
EDW-U063-050	0.500" (1/2")
EDW-U063-063	0.625" (5/8")
EDW-U063-075	0.750" (3/4")
EDW-U063-100	1.00" (1")

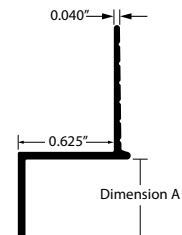

**EDW-Z063**  
**Z Shadow Reveal for 5/8" Drywall**  
EA, MF

Item Number	Dimension A
EDW-Z063-050	0.500" (1/2")
EDW-Z063-063	0.625" (5/8")
EDW-Z063-075	0.750" (3/4")
EDW-Z063-100	1.00" (1")

**Aluminum Reveal Trims** are commonly used in architectural applications such as ceiling to wall transitions, creating visual separation between materials, and producing the look of "trimless" doors and floating wall panels. When used in harmony with finished wall colors, these reveal beads create minimalist shadow lines; when used in contrast with wall material, they produce a stunning design element.

Eagle Aluminum's reveal trims are made from 6063-T5 aluminum which has a smooth surface and is ideally structured for anodized finishing, making it the preferred material for aluminum trim extrusions. These architectural reveal beads are available with .50", .625", .75" and 1.0" reveals for .625" drywall.

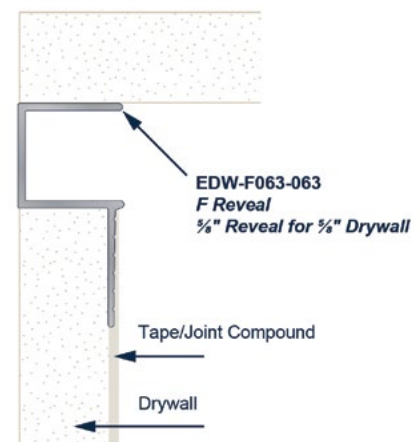

Example Installation: EDW-F063-063, 5/8" F Channel Reveal for 5/8" Drywall Panel

## DRYWALL PROFILES - ½" REVEAL TRIMS

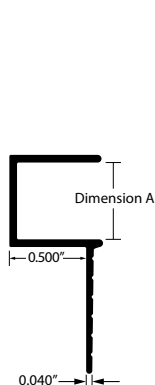
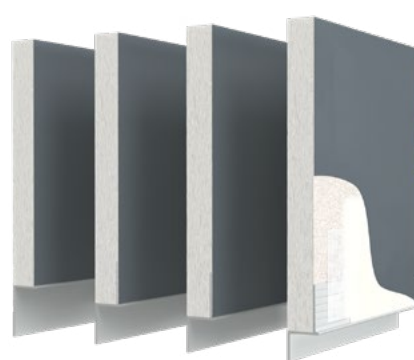
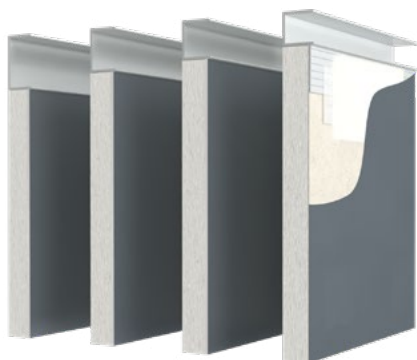

**EDW-F050**

*F Reveal Trim - ½" Drywall*  
EA, MF

Item Number	Dimension A
EDW-F050-050	0.500" (½")
EDW-F050-063	0.625" (⅝")
EDW-F050-075	0.750" (¾")
EDW-F050-100	1.00" (1")

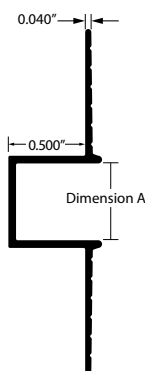

**EDW-U050**

*U Reveal Trim - ½" Drywall*  
EA, MF

Item Number	Dimension A
EDW-U050-050	0.500" (½")
EDW-U050-063	0.625" (⅝")
EDW-U050-075	0.750" (¾")
EDW-U050-100	1.00" (1")

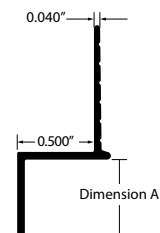

**EDW-Z050**

*Z Shadow Reveal - ½" Drywall*  
EA, MF

Item Number	Dimension A
EDW-Z050-050	0.500" (½")
EDW-Z050-063	0.625" (⅝")
EDW-Z050-075	0.750" (¾")
EDW-Z050-100	1.00" (1")

**Aluminum Reveal Trims** are used to form visually appealing patterns with drywall panels. These architectural reveal beads are available in four reveal widths to provide straight, even lines between drywall panels, crafting a sense of depth and enhancing the aesthetic of any design. Aluminum reveals offer design flexibility and are commonly used in applications such as covering seams, creating visual separation, and producing the look of "trimless" doors and floating walls.

Eagle Aluminum's Drywall Reveal Trims are made from 6063-T5 aluminum, an ideal material for aluminum trim extrusions due to its smooth surface and acceptance of anodized finishing. These architectural reveal trims are available with .50", .625", .75" and 1.0" reveals for .50" drywall.

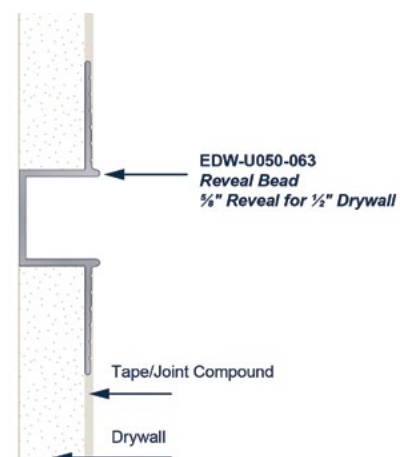

Example Installation: EDW-U050-063, ⅝" U reveal for ½" Drywall



## DRYWALL PROFILES - L BEADS

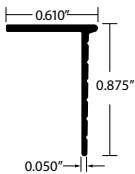

**EDW-L0500**  
**1/2" Drywall L Bead**  
EA, MF

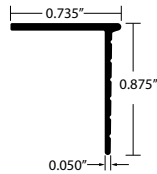

**EDW-L0625**  
**5/8" L Bead**  
EA, MF

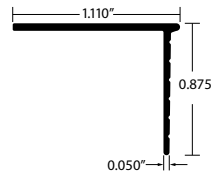

**EDW-L1000**  
**1" L Bead**  
EA, MF

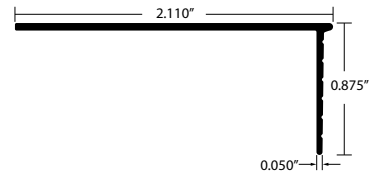

**EDW-L2000**  
**2" L Bead**  
EA, MF

**Aluminum Drywall L Beads**, or L trims, cover the unfinished edge of drywall for a clean and sharp transition from drywall to drywall or drywall to another material. Aluminum L trims are used to create elaborate ceiling designs and elegant flush baseboards. Architectural L beads are also installed around inset doors and windows to achieve flawless window returns.

Eagle Aluminum's drywall L beads are made from 6063-T5 aluminum, an ideal material for architectural trim extrusions due to its smooth surface and ability to accept anodized finishes. L beads are available with a .50", .625", 1.0" and 2.0" finished edge.

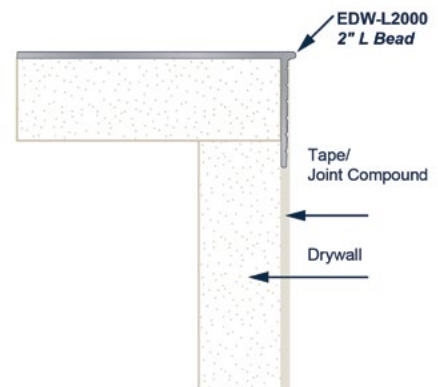

*Example Installation: EDW-L2000, 2" L trim as aluminum window sill.*

## DRYWALL PROFILES - OUTSIDE CORNER TRIM

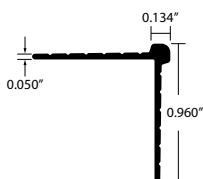
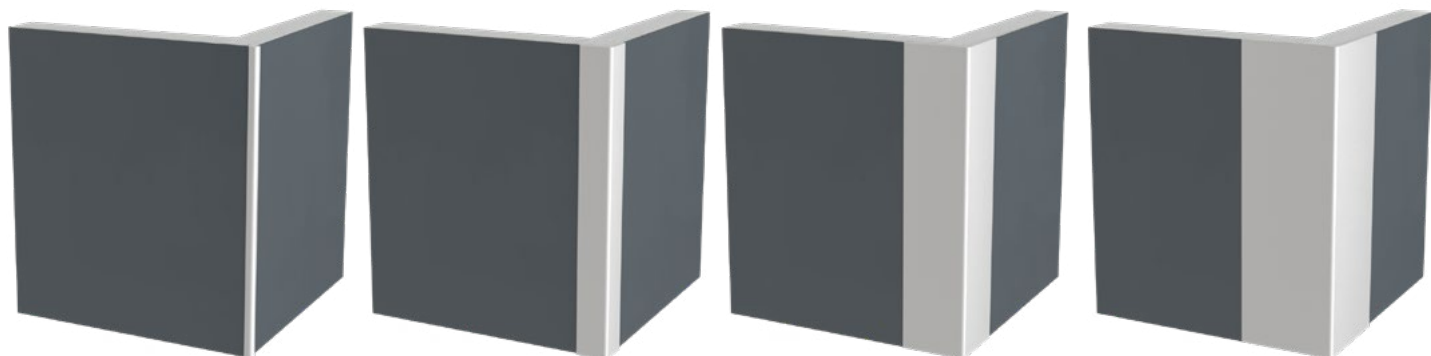

**EDW-OC0125**  
1/8" Outside Corner Trim  
EA, MF

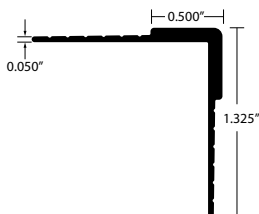

**EDW-OC0500**  
1/2" Outside Corner Trim  
EA, MF

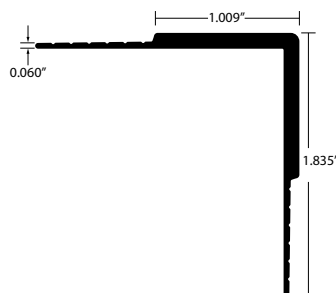

**EDW-OC1000**  
1" Outside Corner Trim  
EA, MF

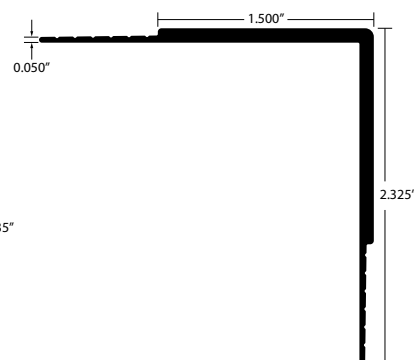

**EDW-OC1500**  
1 1/2" Outside Corner Trim  
EA, MF

**Drywall Outside Corner Trims** provide a clean and polished look for corners where drywall panels meet at a 90-degree angle. Drywall corner beads can be used to create a perfect finished corner with extra durability when they are painted or covered with material to match the wall panels. Corner accent trims can also be used to add a protective and decorative element to any corner when they are anodized or powder coated to compliment wall panel designs. Aluminum corner beads are known for their long-term durability and resistance to wear and tear, making them a reliable choice for projects in areas that are susceptible to physical damage.

Eagle Aluminum's outside corner trims for drywall are made from 6063-T5 aluminum, an ideal material for aluminum trim extrusions due to its smooth surface and ideal structure for anodized finishing.

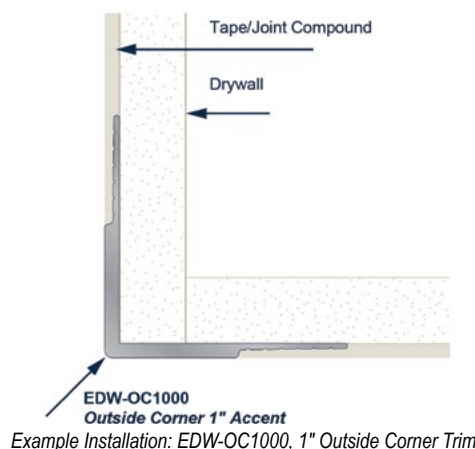

## DRYWALL PROFILES - BASE TRIMS

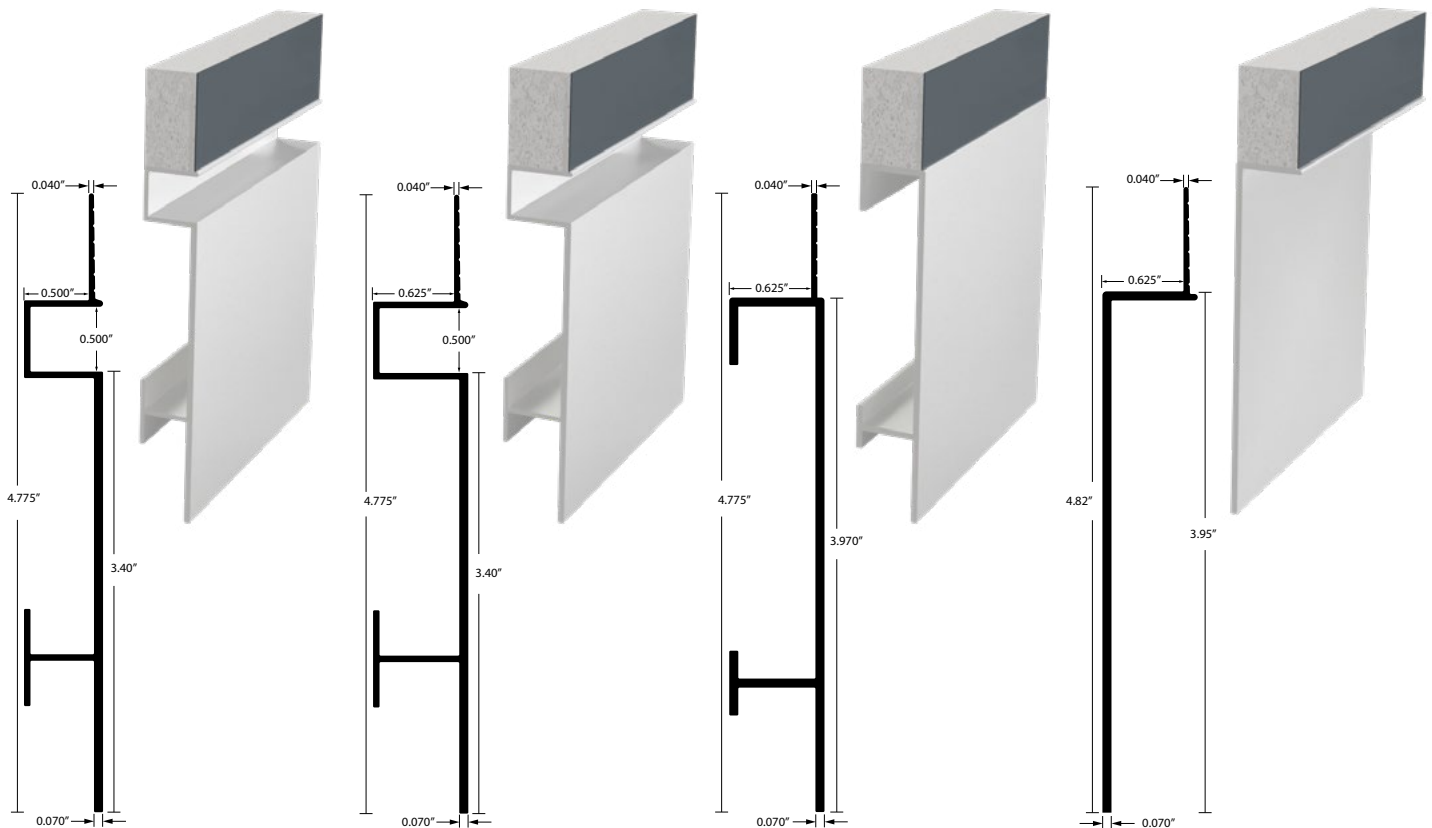

### EDW-B050

**Reveal Base Trim - 1/2" Drywall**  
EA, MF

Item Number	Reveal Height
EDW-B050-050	1/2" Reveal

### EDW-B063

**Reveal Base Trim - 5/8" Drywall**  
EA, MF

Item Number	Reveal Height
EDW-B063-050	1/2" Reveal

### EDW-FB063

**Flush Base Trim - 5/8" Drywall**  
EA, MF

Item Number	Base Height
EDW-FB063-400	4" Base

### EDW-RB063

**Recessed Base Trim - 5/8" Drywall**  
EA, MF

Item Number	Base Height
EDW-FB063-400	4" Base

**Drywall Base Trims** are installed at the bottom of drywall to form a modern, impact resistant base, creating a subtle yet elegant detail in modern residential and commercial construction projects that is more durable and less prone to damage than applied baseboards. Aluminum drywall bases creates strong, crisp outlines in drywall, adding depth and dimension. When used in contrast with wall material, they create an impactful design element; when used in blended colors, they create minimalist shadow lines. Aluminum drywall bases are commonly used in high-traffic commercial settings for giving walls a finished look with lasting durability.

Eagle Aluminum's drywall bases are made from 6063-T5 aluminum which has a smooth surface and is ideally structured for anodized finishing, making it a preferred material for aluminum trim extrusions.

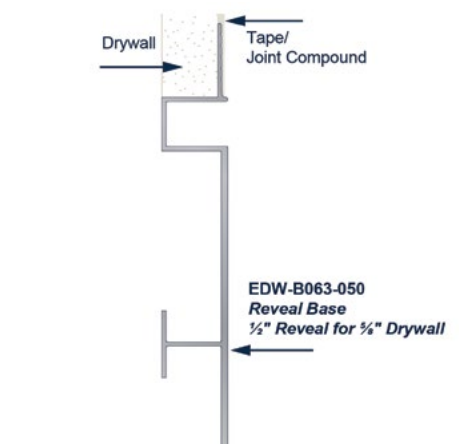

Example Installation: EDW-B063-050, 1/2" Reveal Base for 5/8" Drywall

# EAGLE ALUMINUM DRYWALL PROFILES



50 Medina Street South  
Loretto, MN 55357

1-800-888-2044

[Eagle-Aluminum.com](http://Eagle-Aluminum.com)

© 2025 Eagle Aluminum LLC

EDW V1-07072025